

Rotary Tank Nozzle

Self-Rotating Tank Cleaning Nozzle. Designed for cleaning interior surfaces of tanks, drums, barrels, pipe or tubing. (4) Spinning nozzles travel in an orbital axis for complete coverage. Stainless steel construction, built in strainer, teflon seals and EPDM o-rings are standard. Rated from 5-21 GPM and from 400 to 2000 PSI.

Models are available for fixed rigid pipe mounting or non-rigid hose mounting. Rotation speed is 10 - 16 RPM. Temperatures to 195° F. Inlet is 3/4". Length is 10-1/2". Minimum tank opening is 7-1/2". **(Note: Must specify flow rate, pressure, diameter to be cleaned and if any chemicals will be used).**

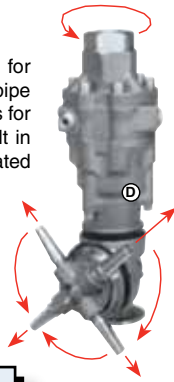

Part No.	Mount	Wt.
IP A80R	Rigid	11 lbs.

Call
Toll Free
For
Prices

Tank Cleaning Nozzles

Designed for cleaning of tanks, barrels and drums. Nozzles spin as main body rotates giving complete orbital coverage to interior surfaces. Rotating bodies are driven by electric or pneumatic motors or are self-propelled and driven by the water flow. Stainless steel construction with built-in filters. (2) or (4) nozzles are included but must be matched to your flow and pressure requirements. Rate to 195° F. **Note: Flow and pressure required for correct sizing as well as tank diameter and any chemicals that may be used.**

M21 Nozzle is rated to 5.5 GPM at up to 3200 PSI. Minimum tank opening is 2-1/2". Electric 110 volt motor is the only drive available for this model. Length is 39". Weight is 7 lbs.

M63 Nozzles are rated from 4 to 6-1/2 GPM and 450 to 2000 PSI. Minimum tank opening is 3-1/4". Self-propelled, 24 volt electric or pneumatic drives are available. Inlet is 3/4" on self-propelled and 3/8" on electric and air models. Length is 48-1/2". Weight is 14 lbs.

M85 Nozzles are rated from 6 to 21 GPM and 450 to 2000 PSI. Minimum tank opening is 6". Self-propelled, 24 volt or pneumatic drives are available. Inlet is 3/4" on self-propelled and 3/8" on electric and air models. Length is 51". Weight is 14 lbs.

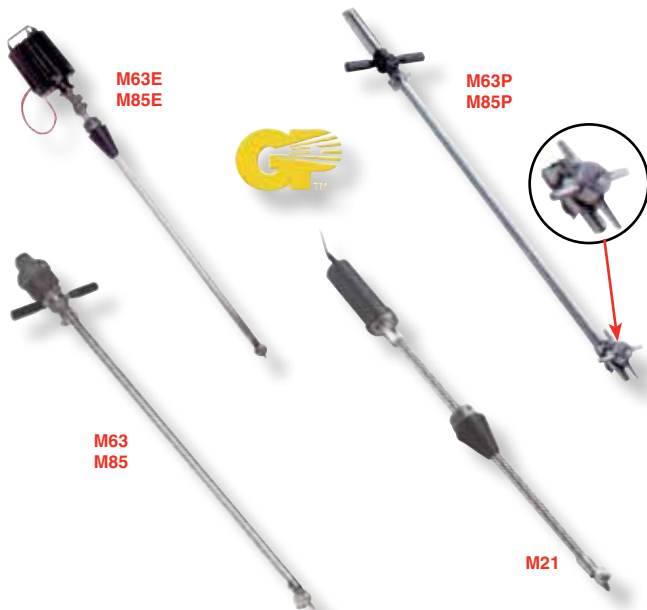

Part No.	Drive	Capacity
IP M21	110V Electric	1.0 - 5.5 GPM
IP M63E	24V Electric	4 - 6.5 GPM
IP M63P	Pneumatic	4 - 6.5 GPM
IP M63	Self-Propelled	4 - 6.5 GPM
IP M85E	24V Electric	6 - 21 GPM
IP M85P	Pneumatic	6 - 21 GPM
IP M85	Self-Propelled	6 - 21 GPM

Rotary Cleaners

An ideal accessory for use with hot or cold water pressure washers. Can be used to clean tanks, ducts, vents, portable toilets, pipe runs and many more. Easily mounted to rigid lance or high pressure hose. Corrosion-resistant, stainless and plated brass construction with self-lubricated bearings and carbide swivels.

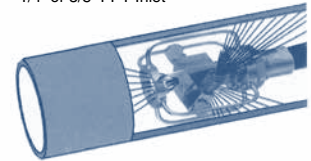
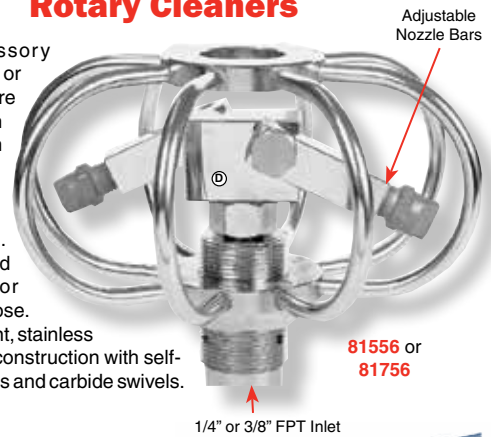

Adjustable 2 or 3 nozzle design is perfect for 360 degree cleaning. (1/8" nozzles are not included and must be matched to your system). Rated to 4000 PSI and 250° F. Inlet is 3/8" FPT. (1/4" also available in all sizes).



No. 81925 Rotary Wand Assembly is a complete wand/rotary cleaner for Portable Toilet Cleanup. Features trigger wand, hose swivel, 40" lance, 6" 3 nozzle adjustable cleaning head with 1502 nozzles.

Part No.	Diameter	Nozzle Type	Wt.
MM 81506	3"	2	1.1 lbs.
MM 81526	6"	2	2.2 lbs.
MM 81556	12"	2	2.8 lbs.
MM 81566	16"	2	3.3 lbs.
MM 81586	24"	2	4.0 lbs.
MM 81706	3"	3	1.1 lbs.
MM 81726	6"	3	2.2 lbs.
MM 81756	12"	3	2.8 lbs.
MM 81766	16"	3	3.3 lbs.
MM 81786	24"	3	4.0 lbs.
MM 81925	Rotary Nozzle Wand Assembly		

Call
Toll Free
For
Prices

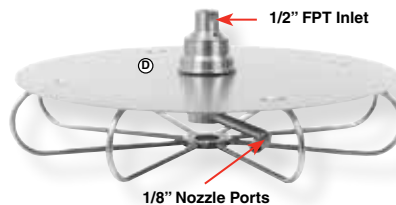

mosmatic
Manhole Cleaners
swiss quality

High Pressure Rotary Cleaners for cleaning, restoration and service of manholes, lift stations and other long vertical drops. Stainless steel construction. Rated to 75 GPM, 2500 PSI and 250° F. Inlet is 1/2" FPT. Designed for (2) 1/8" MPT, zero or 5 degree nozzles matched to your pump output (Nozzles are sold separately, call for details). Available in a variety of diameters to meet your needs.



Part No.	Size	Wt.
MM 81037	12" Diameter	8.1 lbs.
MM 81047	16" Diameter	8.0 lbs.
MM 81057	20" Diameter	11.7 lbs.
MM 81067	24" Diameter	14.0 lbs.
MM 81087	32" Diameter	17.0 lbs.

Call
Toll Free
For
Prices