

## No. 2835 for Viscous Liquids



**ROPER'S 2835 ROTARY PUMP** is designed for use in pumping of viscous liquids. Capacities to 11 GPM at 1750 RPM. Can be direct connected to standard electric motor (1750 or 1200 RPM). Self priming to approximately 8 ft. with foot valve for initial prime. **Note: Do not run dry.**

In the high position the 1/2" drive shaft will align with a NEMA 56, 143T or 145T motor shaft for direct drive. In the low position it will align with a NEMA 48 frame motor. Use 1-1/2 HP motor (clockwise rotation facing shaft is not reversible).

External helical gear design, coupled with 1-1/2" ports, allow highly viscous liquids (up to 100,000 SSU) to be pumped at speeds up to 1750 RPM. The bearings are lubricated by the liquid being pumped. With only two moving parts, Roper's long-lived helical gears, the pump runs quietly.

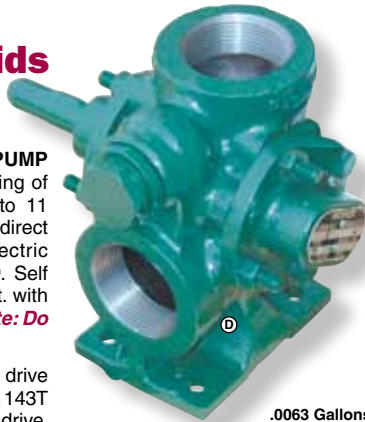

.0063 Gallons Per Revolution



Housing	Gears	Bearings	Shafts
Cast Iron	Hardened Steel	Iron	Hardened Steel

- 1-1/2" FPT ports • 1/2" Keyed Drive
- Lip Seal: Teflon-Viton® or Packing: Graphite or Teflon

Part No.	ROPER VISCOUS LIQUID PUMP	Wt.
RR 2835L	Gear Pump, with Lip Seal.....	11 lbs.
RR 2835P	Gear Pump, with Packing Gland .....	11 lbs.
RR G17-71	Replacement Lip Seal.....	-
RR N43-32	Replacement Packing Seal (Graphite)	-
RR N43-109	Replacement Packing Seal (Teflon)	-

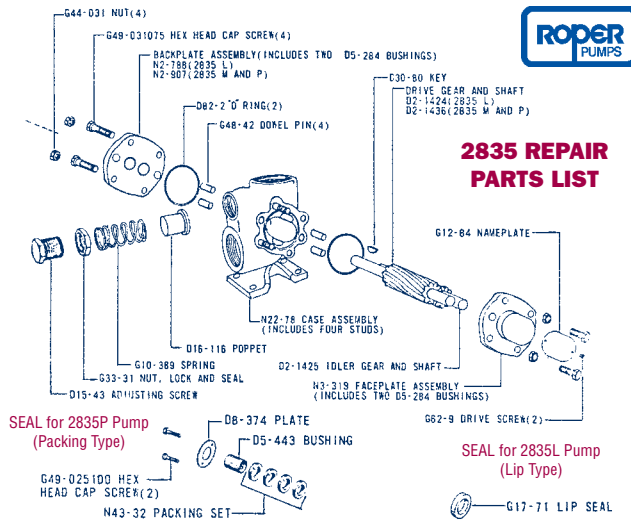

## Integral Bi-Directional Relief Valve



- Available for 3600 & 3700 Series Pumps
- Bolts to Existing Pumps
- Torture Tested - Life Exceeded 12,000 Fully Reversed Cycles

Part No.	Bi-Directional Relief Valve for:
RR N7-901	3611, 17 & 22 Pumps.....
RR N7-909	3648 & 3748 Pumps.....

Viton® is a registered trademark of DuPont Performance Elastomers



## 3800 Series Gear Pumps

- Suitable for Waste Oil, Spent Fuels, Hot Oils, Light & Heavy Crude Oils, Condensates & Kerosene Mixtures.
- Pressures to 125 PSI
- Flow Rates to 540 GPM & Temperatures to 250° F.
- Hardened Gears & External Sealed Ball Bearings
- Triple Shaft Seals

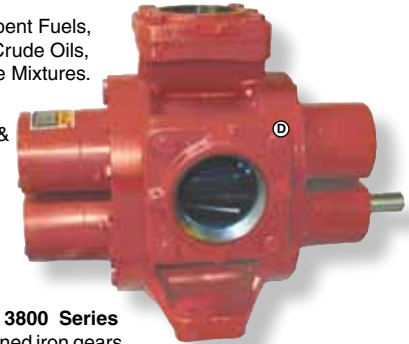

These heavy-duty **Roper 3800 Series Gear Pumps** include hardened iron gears.

In addition, the external sealed ball bearings are protected from the liquid by the triple shaft seals (*grease purged*), which extends the pump life significantly when pumping dirty liquids. These 3800 series pumps also include steel shafts, cast iron housings and overpressure relief type grease fittings. Suitable for waste oil and spent waste fluids, hot oils and oil field applications including light and heavy crude oils, condensates and kerosene mixtures. Four sizes with pressures to 125 PSI, flow rates to 540 GPM and temperatures to 220° F. with standard buna lip seals (*Viton® available, 250° F.*). All ports are bolt on, FPT flanges for easy pipe removal in the field. Built-in relief valve available on 3848FRV model.

Part No.	Gear Pump	Flowrate Per 100 RPM	Built-In Relief Valve	Wt.
RR 3832F	3" FPT	32 GPM	No	80 lbs.
RR 3843F	3" FPT	43 GPM	No	80 lbs.
RR 3848F	4" FPT	52 GPM	No	90 lbs.
RR 3848FRV	4" FPT	52 GPM	No	90 lbs.
RR 3858F	4" FPT	60 GPM	No	90 lbs.



## 3" Rubber Gear Pumps Roper 5600 Series

### APPLICATIONS

- Oil Field Service • Brine & Raw Water • Sludges & Slurry • Waste Oils, Tallow, etc. • Sealant Coats • Molasses Feeds • Fertilizers
- Paper Pulps • For Fixed or Mobile Transfer

### FEATURES

- Reversible Rotation & Flow
- Interchangeable Parts with Bowie's 3300
- Cast Iron Construction
- External Greasing
- Rubber Covered Gears
- Non-Pulsating Flow
- 100 PSI Maximum Pressure
- 10,000 SSU Maximum Viscosity
- Maximum Speed - 400 RPM
- Pumps Supplied Without Relief Valve
- 3" FPT Bolt On Ports

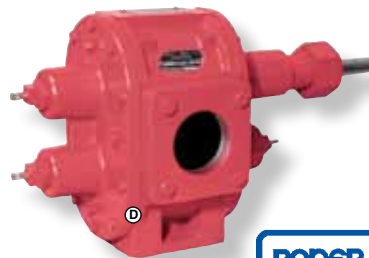

### Roper 5600 Series

Part No.	Port Size	Capacity @ 50 PSI & 400 RPM	Shaft	Wt.
RR 5658	3" x 3"	209 GPM	1-3/8"	142 lbs.

**NOTE:** Pumps supplied without relief valve.

**NOTE:** Parts are interchangeable with Bowies 2300 & 3300 Series.



**N44-359 Repair Kit Includes:**  
Drive Gear/Shaft Assembly  
Idler Gear/Shaft Assembly  
Bronze Bearings  
Packing Rings  
Case Gasket

### Repair Kits & Parts

Part No.	Repair Kit for 5658 Pump.....
RR N44-359	Repair Kit for 5658 Pump.....
RR P23-151	3" FPT Flange for 5658 Pump.....
RR D11-615	3" Flange Gasket for 5658 Pump ..
RR G49-050150	Flange Screws for 5658 Pump .....

**NOTE:** You Need (2) Flanges, (2) Gaskets & (8) Flange Screws per Pump.