

## PACER Thermoplastic Pumps

Use of tough engineering thermoplastic makes this a desirable pump for pumping liquid products. The pump "castings" are made of thermoplastic polyester which is noted for its outstanding chemical resistance. EPDM mechanical seals are standard. Viton® also available.

### Self-Priming Poly Centrifugal Pumps 1-1/2" • 2" • 3" • Engine & Hydraulic Drive



**HIGH CAPACITY - PROTECTED SEAL  
DURABLE - MADE OF PARTS  
THAT WILL NOT RUST OR CORRODE**

**INTERCHANGEABILITY OF PARTS** - All internal parts are interchangeable on 1-1/2" & 2" size (Pacer). **Note:** Hydraulic Units have same pump specifications.

**PUMPS CAN BE USED FOR:** Water, most fertilizers and deicing liquids. Most diluted agchemicals compatible with EPDM seal.

**FEATURES:** Lightweight corrosion-resistant thermoplastic polyester construction resists corrosion. **FAST PRIMING** - Will lift 25 feet in less than one minute. **HIGH CAPACITY** - 1-1/2" size will pump 100 GPM; 2" size will pump 150 GPM and 3" size will pump 200 GPM.

**PROTECTED SEAL** - Pump out vanes on back of impeller reduces pressure and eliminates dirt in the seal area.

Part No.	Pump Style	Ports	Wt. Lbs.
PR SE1-1/2PL	4 HP Briggs Engine	1-1/2" FPT	36
PR SEB2PLE	4 HP Briggs Engine	2" FPT	40
PR SEB2PLE5.5	6 HP LCT OHC Engine	2" FPT	47
PR SE2UL	5.5 HP Briggs 950 Engine	2" FPT	46
PR SE2ULE5HC	5.5 HP Honda Engine	2" FPT	45
PR SE2ULE6HCP	6.5 HP Honda Engine	2" FPT	50
PR SE2RLE5PROTK	6.5 HP Briggs PRO **	2" FPT	48
PR SE3SLE6HCP	6.5 HP Honda Engine	3" FPT	50
PR SE3SLE6CP	6.5 HP Briggs Vanguard Engine	3" FPT	57
PR SE3XLE8CP	* 8 HP Briggs Vanguard Engine	3" FPT	71
PR SE2ILHYC	2" Hydraulic Pump Unit	2" FPT	16
PR SE3LLHYC	3" Hydraulic Pump Unit	3" FPT	18
PR 0005	EPDM Seal & O-Ring Kit for Pacer Pumps		1
PR 0017	Viton® Seal & O-Ring Kit for Pacer Pumps		1
PR 702EPU	EPDM Rebuild Kit w/Impeller, Volute, & Seal Kit		1
PR SE2ULKIT	Pump Only for SE2UL Only		1

\* With Roll Cage. \*\* Includes "PROTECT" Seal Feature (Large Cavity & Oversized Slinger).

### Self-Priming Pedestal Pumps



**Stainless Pump mounted to cast iron bearing pedestal**



**Poly Pump mounted on cast-iron bearing pedestal**

**Pedestal Pumps** are available in 2" and 3" sizes for long coupled applications with gasoline engine or electric motor power. Pumps must run at 3450 RPM. (Heavy-duty Cast Iron Bearing Pedestal and EPDM seals are standard). The "I" Series Models are available in an epoxy coated or stainless housing. Connections on the "I" Series are 2" MPT and 1-1/2" FPT ports. The clamping band holds the pump housings together and permits easy take-down for cleaning and maintenance. **SE2JB** and **SE2JV Series** are high flow pumps with Buna or Viton® seals. See performance chart upper right side of this page (2" High flow models). Temperature Range: -10° F. to 130° F.

Part No.		Ports	* HP	Shaft Req'd.	Size	Wt. Lbs.
PR SE2ELCSS	Pacer Pump, Cast Iron Pedestal	2" x 2"	2	3	3/4"	15
PR SE2HLCSS	Pacer Pump, Cast Iron Pedestal	2" x 2"	2	3	3/4"	15
PR SE2FLCSS	Pacer Pump, Cast Iron Pedestal	2" x 2"	5	3	3/4"	15
PR S3A-097	Pacer Pump, Cast Iron Pedestal	3" x 3"	7-1/2	3	3/4"	15
PR ISEFP2GLCSS	Stainless Pump	*2" MPT & 1-1/2" FPT	5	5	3/4"	27
PR SE2JBCSS	Pacer Pump, Buna, CI Pedestal	2" x 2"	5	3	3/4"	13
PR SE2JVCSS	Pacer, Pump, Viton® CI Pedestal	2" x 2"	5	3	3/4"	13

\* HP required at 1.4 S.G. liquids.

Viton® is a registered trademark of DuPont Performance Elastomers

## Poly Transfer Pumps (Motor Drive)

Fertilizer transfer units, with **PACER** glass-filled polyester centrifugal pumps, have a *Lovejoy* shaft coupling with safety shield between the motor and pump shaft. EPDM mechanical seals. Units with TEFC, 3450-RPM, one or three phase motors in 2, 3, 5, 7-1/2 and 10 HP are available. Do not pump substances which have pH factor of over 10 or a temperature of over 160° F. The PERFORMANCE CHART is based on water. **NOTE: DO NOT USE STANDARD 3 HP SIZE FOR LIQUIDS HEAVIER THAN WATER - USE 3010-E instead.**

### 2 HP to 10 HP Self-Priming



HEAD (in feet)	10	20	30	40	50	60
PRESSURE (PSI)	4.3	8.7	13.0	17.3	21.7	26.0
SIZE HP						
2" 2 GPM	120	100	80	60	50	25
2" 3 GPM	175	160	155	140	125	100
2" 5 GPM	175	165	150	135	125	100
* 2" 5 GPM	240	230	215	190	155	115
3" 7-1/2 GPM	275	275	250	220	180	150
3" 10 GPM	350	350	330	320	275	240

\* High flow units.



PR2010

**NOTE:** 3" Units not available with the carrying handle.



Part No.	Ports	HP	Phase	Max. Specific Gravity	Volts	Wt. Lbs.
DU PR2010	2"	2	1	1.2	115/230	85
DU PR2030	2"	2	3	1.2	230/460	80
DU PR3010	2"	3	1	1.0	115/230	120
DU PR3010-E	2"	3	1	1.7	115/230	120
DU PR3030	2"	3	3	1.0	208/230/460	100
DU PR5010	2"	5	1	1.4	230	130
DU PR5030	2"	5	3	1.4	208/230/460	110
DU PR5010A	*2"	5	1	1.4	230	180
DU PR5030A	*2"	5	3	1.4	208/230-460	110
DU PR5030B	#2"	5	3	1.4	208/230-406	110
DU PR7510	3"	7-1/2	1	1.4	230	165
DU PR7530	3"	7-1/2	3	1.4	208/230/460	140
DU TK300PBW-10-3	3"	**10	3	1.4	230/460	200

\* High flow series with Buna seal. # High Flow Series with Viton® Seal. Both with 975.30 Impeller.

\*\* Banjo Pump w/ Double Viton® Seal.

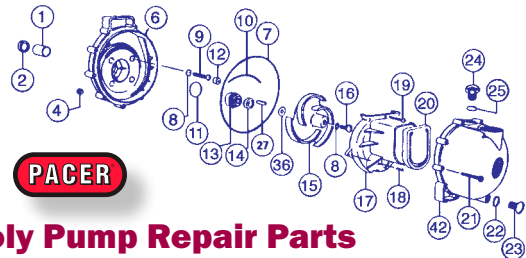

### Poly Pump Repair Parts

Part No.	Ref. #	Description	Per Pump
PR 884.71	2	Slinger, Buna-N	1
PR 721.10	4	Nuts, Body, SS	10
PR 703.30B	6	Bracket	1
PR 719.72	7	O-Ring, Body, EPDM	1
PR 171.72	*8	O-Rings, Screw, EPDM	5
PR 715.10	9	Screws, Bracket	4
PR 754.72	*10	O-Ring Segment, EPDM	1
PR 976.72	*11	O-Ring, Shaft Seal, EPDM	1
PR 750.40	12	Plug	4
PR 714.12	*13-14	EPDM Shaft Seal	1
PR 714.14	13-14	Viton® Shaft Seal	1
PR 667.30	15	Impeller, 3 Vane, .535" Wide, 4.75" Diameter	1
PR 704.30	15	Impeller, 3 Vane, .535" Wide, 5.50" Diameter	1
PR 974.30	15	Impeller, 4 Vane, .600" Wide, 4.75" Diameter	1
PR 975.30	15	Impeller, 4 Vane, .975" Wide, 4.75" Diameter	1
PR 706.30	15	Impeller, 5 Vane, .535" Wide, 5.50" Diameter	1
PR 716.10	*16	Screw, Impeller, SS	1
PR 702.30	17	Volute, Flat	1
PR 725.10	*18	Screw, Side Volute	2
PR 771.10	*19	Screw, Top Volute	1
PR 705.72	20	Check Valve, EPDM	1
PR 720.10	21	Screws, Body, SS	10
PR 1009.72	22	O-Ring, Drain Plug, EPDM	1
PR 723.30	23	Plug, Drain	1
TK 12777	24	Plug, Filler	1
PR 765.72	*25	O-Ring, Fill Plug, EPDM	1
PR 718.10	*27	Key, SS, 1" Long	1
PR 759.20	31	Bearing Pedestal	1
PR 777.00	32	Bearing/Shaft Assembly, STD	1
PR 0778.11	*36	Shim (part of repair kit)	1
PR 1001.30A	42	Smooth Body 1-1/2" NPT	1
PR 1002.30B	42	Smooth Body 2" FPT	1

\* INCLUDED IN 0005 EPDM REPAIR KIT. VITON® REPAIR KIT 0017